

SRT11 MODEL

1 kVA ~ 3 kVA
PF 0.9



Features

- High frequency On-Line double conversion technology
- DSP (Digital signal processors) control technology
- Active power factor correction (APFC), input power factor up to 0.99
- Output power factor 0.9
- Wide input voltage range (110 V ~ 300 Vac) and frequency range (40 ~70 Hz)
- Auto sensing frequency
- 50/60 Hz frequency conversion
- Cold start
- Rear ventilation design and variable speed fan
- Effective software and hardware protection
- Quick and stable charging , %90 capacity restored in4h (standart model UPS)
- Linear derating in low voltage input reducing battery discharging times
- Settable delayed start when power is restored
- Hot-swappable battery
- Multiple functions settable via LCD: output voltage,EOD , auto-start, bypass mode, ECO mode and frequency conversion mode
- Multi-platform communications: RS232 (standart) , USB/RS485/SBMP/ dry contacts (optional)
- Optional USB, RS485 card, AS400 dry contacts , SNMP card, SMS alarms, EPO funtion, MBS (External maintenance bypass switch)

Rear Panel

1. Ac input socket
2. Battery connector (Optional)
3. Fan
4. USB (Optional)
5. EPO (Optional)
6. RS232
7. Intelligent slot (Optional)
8. Output sockets

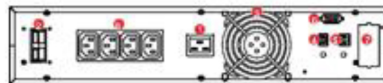

1kVAS

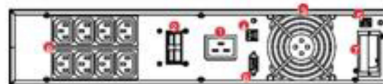

2kVAS

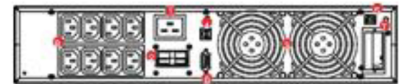

3kVAS

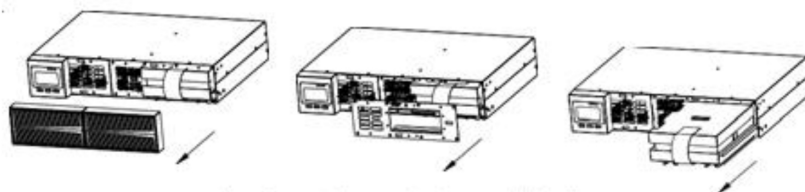

Easy for maintenance, hot-swappable battery

Specifications

MODEL	SRT11 1 Kva	SRT11 2 Kva	SRT11 3 Kva
Capacity	1Kva/900W	2 Kva/1800W	3 Kva/2700W

INPUT	
Rated voltage	208/220/230/240 Vac
Voltage range	110 ~176 Vac (linear derating between 50% and 100% load),176~280 Vac (ne derating): 280 ~300 Vac (derating 50%)
Frequency	40~70 Hz (auto-sensing)
Power factor	≥0.99
Bypass voltage range	-25%~+15%(settable)
Total harmonic distortion	≤6%

OUTPUT	
Voltage	208/220/230/240 Vac (settable via LCD)
Voltage regulation	±1%
Frequency	40~55 Hz or 55~65 Hz (synchronized range): 50/60 Hz ±0.1 Hz (battery mode)
Waveform	Sinusoidal
Power factor	0.9
Total harmonic distortion (THDv)	≤2% (linear load): ≤5% (non-linear load)
Crest factor	03:01
Overload	105% ~125% for 1 min. 125% ~150% for 30 s. >150% for 300 ms

BATTERIES								
Dc voltage	24 V(S)	36 V(S)	36 V (H)	48 V(S)	72 V (S)	72 V (H)	72 V(S)	96 V (H)
Inbuilt battery	2x7 Ah	3x7 Ah	/	4x9 Ah	6x7 Ah	/	6x7 Ah	/
Charging current (max.)	1A		6 A	1 A		6 A	1 A	6 A
Recharger time	Standart model : 90% capacity restored in 3 hours; Long time model : depend on the capacity of battery							

SYSTEM			
Efficiency	≥90% (Mains mode)	≥ 91% (Mains mode)	≥92% (Mains Mode)
	≥85% (Battery mode)	≥86% (Battery mode)	≥87% (Battery mode)
	≥ 95% (ECO mode)	≥ 96%(ECO mode)	≥ 97% (ECO mode)
Transfer time	Mains mode to battery mode: 0 ms. Inverter mode to bypass mode: 4 ms (typical)		
Protections	Short-circuit,overload,overtemperature,battery dischargeprotection and fan testing protection		
Communications	RS232 (standard) , USB/dry contacts /SNMO (optional)		
Display	LCD + LED		

Standart	EN62040-1, EN 62040-2 , EN 61000-3-3, IEC 61000-4-2, IEC 61000-4-3, IEC 61000-4-4, IEC 61000-4-5, IEC 61000-4-6, IEC 61000-4-8, IEC 61000-4-11, IEC 61000-2-2, IEC 62040-2, IEC 62040-1
----------	---

OTHERS								
Operating temperature	0°C-40°C							
Storage temperature	-25°C-55°C (without batteries)							
Relative humidty	0 ~95%(non-condensing)							
Altitude	≤1000m. Derating 1% for each additional 100 m							
IP rating	IP 20							
Noise level at 1m	≤50 dB							
Dimension (Wx D x H) mm	440 x 338x 88	440x430x 88	440x468x 88	440x430x 88	440x560x 88	440x468x 88	440x560x 88	440x468x 88
Packaged dimension(Wx D x H) mm	545x428x 194	545x560x 201	545x592x 201	545x560x 201	545x690x 201	545x592x 201	545x690x 201	545x592x 201
Net weight (kg)	10,6	15,5	7,6	18,7	25,6	9,7	26,8	10,1
Gross weight (kg)	11,3	18,6	11,1	21,8	25,8	13,2	29,7	13,6

• Derate capacity to 70% in CUCF mode and to 90% when the output voltage is adjusted to 208 Vac.
• S means standard model, H means long time model.

• All specifications are subject to change without notice.
• Custom-made specifications are acceptable.