

Specifications

| | | |
|----------------------|--------------|---------------------|
| Nominal Voltage | | 12 V |
| Rated capacity(10HR) | | 65Ah |
| Dimension | Length | 350±2mm (13.78inch) |
| | Width | 166±2mm (5.54inch) |
| | Height | 179±2mm (7.05inch) |
| | Total Height | 179±2mm (7.05inch) |
| Approx. Weight | | 20.4kg (45.0lbs)±3% |

Dimensions

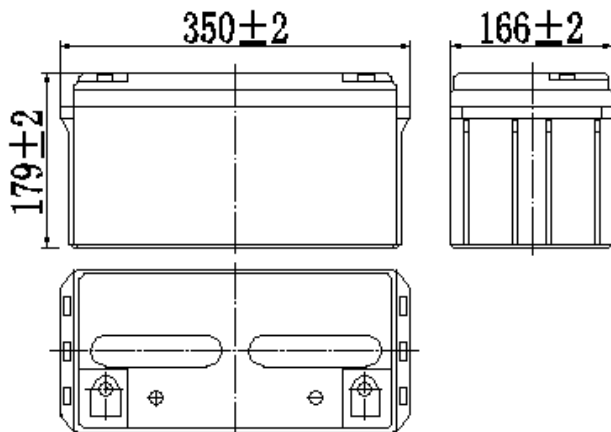

Terminal

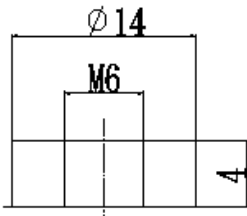

Characteristics

| | | |
|---|-------------|---|
| Capacity (25°C) | 10HR(10.8V) | 65 Ah |
| | 3HR(10.8V) | 48Ah |
| | 1HR(10.5V) | 36Ah |
| Terminal type | | T14 |
| Internal resistance (Fully charged, 25°C) | | Approx.6.5mΩ |
| Capacity affected by temperature (10HR) | 40°C | 102% |
| | 25°C | 100% |
| | 0°C | 85% |
| | -15°C | 65% |
| Self-discharge (25°C) | 3 month | Remaining Capacity: 91% |
| | 6 month | Remaining Capacity: 82% |
| | 12 month | Remaining Capacity: 65% |
| Nominal operating temperature | | 25°C±3°C(77°F±5°F) |
| Operating temperature range | Discharge | -15°C~50°C(5°F~122°F) |
| | Charge | -10°C~50°C(14°F~122°F) |
| | Storage | -20°C~50°C(-4°F~122°F) |
| Float charging voltage(25°C) | | 13.50 to 13.80V Temperature compensation: -18mV/°C |
| Cyclic charging voltage(25°C) | | 14.50 to 15.00V Temperature compensation: -30mV/°C |
| Maximum charging current | | 19.5A |
| Terminal material | | Copper |
| Maximum discharge current | | 650A(5 sec.) |
| Designed floating life(20°C) | | 10 years |

Construction

| | | | | | | | | |
|--------------|----------------|----------------|-----------|-------|-----------|---------------|--------------|----------|
| Component | Positive plate | Negative plate | Container | Cover | Separator | Electrolyte | Safety valve | Terminal |
| Raw material | Lead dioxide | Lead | ABS | ABS | AGM | Sulfuric acid | Rubber | Copper |

Constant Current Discharge Characteristics (A, 25°C)

| F.V/TIME | 5min | 10min | 15min | 30min | 60min | 3h | 4h | 5h | 8h | 10h | 20h |
|----------|-------|-------|-------|-------|-------|------|------|------|------|------|------|
| 9.60V | 193.0 | 138.9 | 108.8 | 65.3 | 40.2 | 17.1 | 13.7 | 11.7 | 8.02 | 6.62 | 3.51 |
| 9.90V | 181.2 | 131.9 | 103.5 | 64.0 | 39.6 | 17.0 | 13.6 | 11.6 | 7.98 | 6.60 | 3.50 |
| 10.2V | 168.3 | 125.0 | 98.0 | 62.1 | 38.6 | 16.9 | 13.5 | 11.5 | 7.92 | 6.58 | 3.49 |
| 10.5V | 149.4 | 117.4 | 92.6 | 60.6 | 37.4 | 16.8 | 13.4 | 11.4 | 7.87 | 6.55 | 3.47 |
| 10.8V | 129.2 | 105.4 | 86.0 | 58.3 | 36.2 | 16.3 | 13.0 | 11.1 | 7.63 | 6.50 | 3.45 |

Constant Power Discharge Characteristics (Watt, 25°C)

| F.V/TIME | 5min | 10min | 15min | 30min | 60min | 3h | 4h | 5h | 8h | 10h | 20h |
|----------|------|-------|-------|-------|-------|-----|-----|-----|------|------|------|
| 9.60V | 2168 | 1561 | 1222 | 733 | 458 | 201 | 161 | 138 | 95.3 | 79.0 | 42.1 |
| 9.90V | 2099 | 1528 | 1199 | 718 | 451 | 200 | 160 | 137 | 94.7 | 78.9 | 42.0 |
| 10.2V | 2008 | 1492 | 1170 | 696 | 440 | 199 | 159 | 136 | 94.1 | 78.6 | 41.9 |
| 10.5V | 1835 | 1442 | 1137 | 679 | 426 | 197 | 157 | 135 | 93.4 | 78.2 | 41.6 |
| 10.8V | 1633 | 1332 | 1087 | 655 | 412 | 191 | 153 | 131 | 90.6 | 77.6 | 41.3 |

Note: The above characteristics data can be obtained within three charge/discharge cycles.

Sealed Lead-Acid Batteries

Discharge Characteristics(25°C)

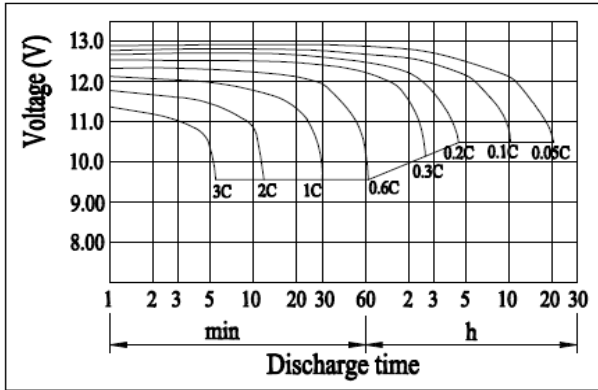

Charging Characteristics(25°C)

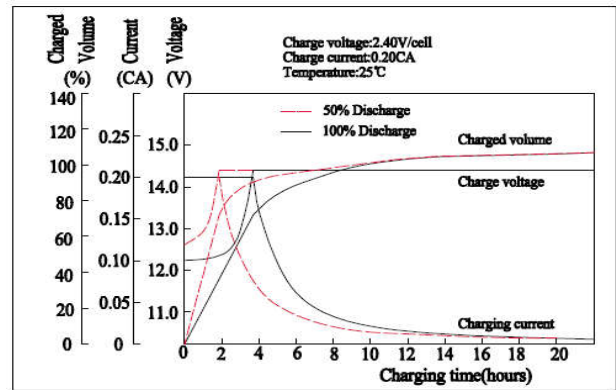

Effect of Temperature on Capacity

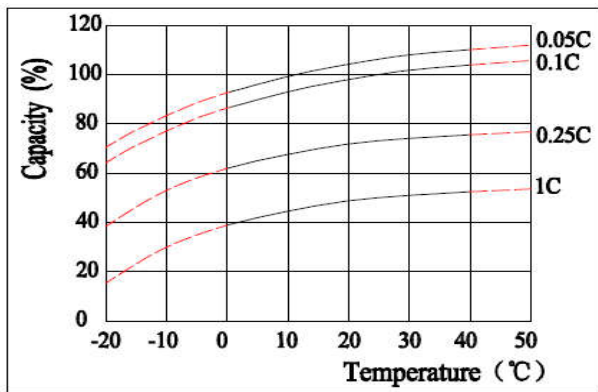

Self-discharge Characteristics

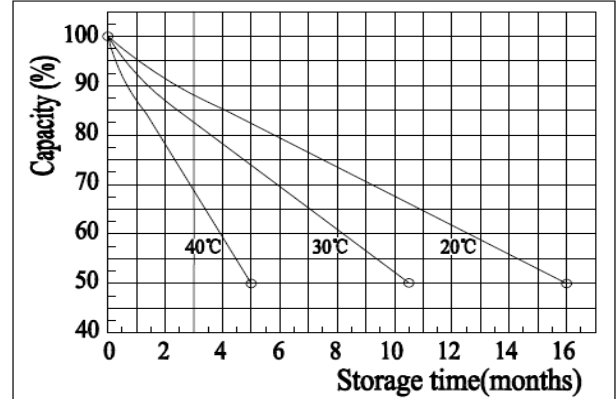

Floating Life on Temperature

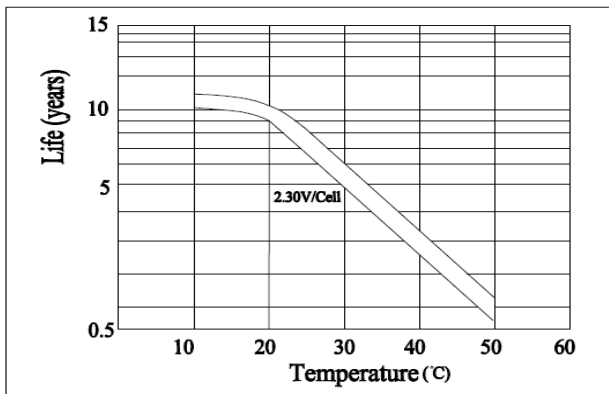

Cycle Life on D.O.D.(25°C)

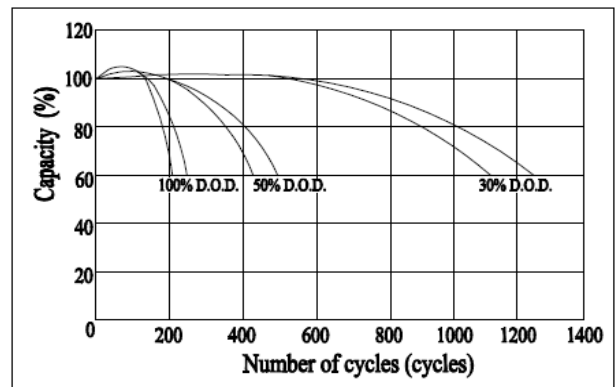

The Relationship for Open Circuit Voltage and Residual Capacity (25°C)

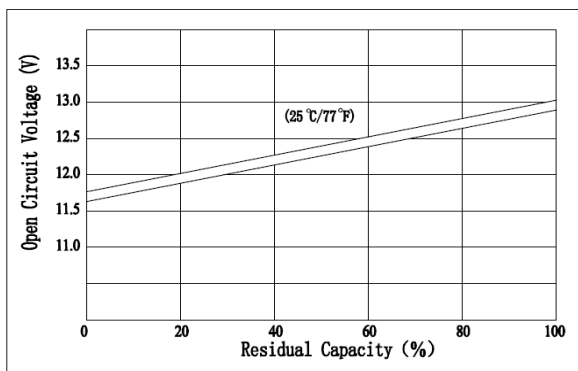

The Relationship for Charging Voltage and Temperature

